

display, parade, celebrate!

Gecina reveals its property portfolio in a new light to make your communication an event.

experiences
by Gecina

The art of innovative communication

In Paris' most beautiful buildings, anything is possible: grand openings, amazing events, pop-up shops, fashion shows, new product launches, elegant private dinners, meetings, artistic performances...



Spectacular work of art on the Louis Vuitton flagship store, 101 Champs-Élysées.



Window display for MESSIKA at 44 avenue des Champs Élysées



Exclusive dinner on the rooftop of 24-26 rue Saint Dominique

Go for something new

Let Gecina exclusively reveal its properties to you in a **new light**. Step inside and bring your communication and event projects to life to reach **all of your audiences**.

Embrace the unpredictable

You get to pick **the place and the vibe**: cool and private spots, impressively large spaces with a raw concrete look, rooftops with amazing views over Paris, and hidden gardens..

experiences guides you

Got an idea? A dream? A project? **Tell us about it, we will help you find the ideal place.**

display — parade — celebrate



Get your brand noticed big time by **leveraging the exceptional visibility of Gecina's properties during construction**. Our market-leading partners are here to help you.

Already a client? **Turn your building's facade into a giant billboard.**



Embrace **the raw, the exclusive, the ephemeral**: our spaces, before renovation, transform properties into sought-after venues for **Fashion Week shows**, product launches, and **pop-up stores**.



And to round things off in style: gourmet dining under the stars, exclusive private parties, unforgettable summer parties... **create memories that last a lifetime.**

experiences beyond the ordinary

Our most stunning achievements

- Messika High Jewellery Show and Champs Élysées advertising showcase
- Contemporary art exhibition Paris Internationale
- We Are Ona culinary experience
- Artistic creation by Georges Rousse
- Valentino open-air dinner
- Courrèges after show
- Off White and L'Oréal showroom and fashion show preparation,
- Gucci large-format ad on Rue Royale

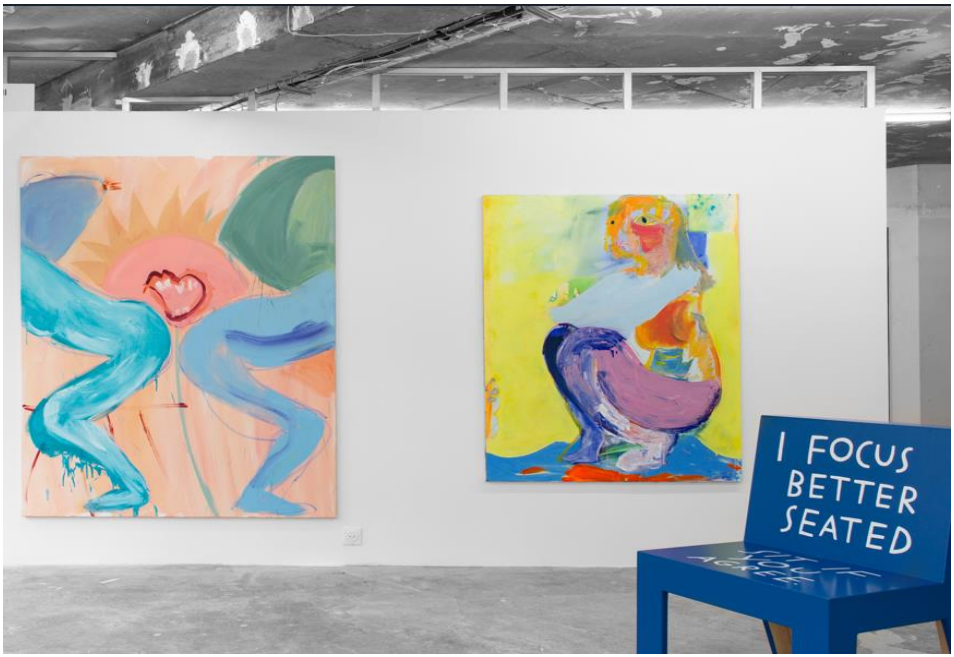









Les Arches du Carreau

2025

About the property

-  Major thoroughfare between Pont de Neuilly and Place de l'Étoile - 10 minutes from Paris
-  80 m long building
-  In the vibrant heart of the Allées de Neuilly
 - Very bright - Generous volumes.
-  Available until 2026

Technical features

Advertising :

- In collaboration with our partners, leaders in advertising management.
- 1,200 sq.m. of total advertising space
- Avenue Charles-de-Gaulle: 40 sq.m. long by 20 sq.m. tall
- Les Halles Gourmandes: 20 sq.m. long by 20 sq.m. tall

Events :

- Perfect for fashion shows, showrooms, cocktails, private dinners...
- A 1,500 sq.m. rooftop for exceptional receptions and celebrations
- Ceiling heights up to 2.70 m
- 3 elevators (750 kg capacity - 10 people)
- 1 sanitary block and a 150 sq.m. marketing suite on the 7th floor, currently being renovated.





Jardin Vendôme

All year round



"Discover a hidden gem, a garden that celebrates the rich heritage of this iconic location.

Inspired by the convent gardens of the past, this contemporary space blends harmoniously with the elegant architecture of the neighbourhood, offering a unique glimpse into the history of Place Vendôme."

Gabriel Rochard,
Founder of Atelier Gabriel



About the property

- 📍 Place Vendôme
- 🏠 800 sq m garden, capacity for 200-220 guests
- ⊕ Filled with light and greenery
- 🕒 Available for night-time use
- 🍹 Cocktails, photo shoots, dinners, fashion shows ...

Technical features

- Landscaping done by Atelier Gabriel and inaugurated in 2021
- Several possible entrances
- Parking spaces available
- Equipped with water, electricity and toilets
- Year-round cleaning and gardening services

experiences



Rooftop Pergolèse



All year round

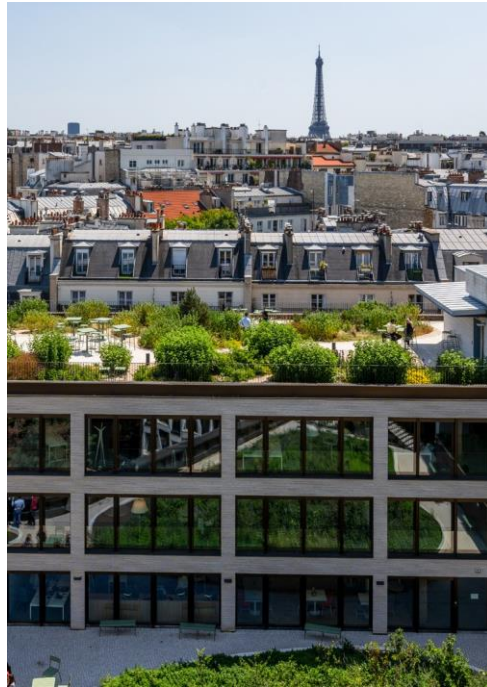

About the property

- Rue Pergolèse near the Étoile
- 400 sq ft landscaped rooftop garden
- Lush greenery
- Perfect for cocktails and private gatherings
- Available year-round

Technical features

- Equipped with water, electricity and toilets
- Cleaning services
- Year-round gardening services

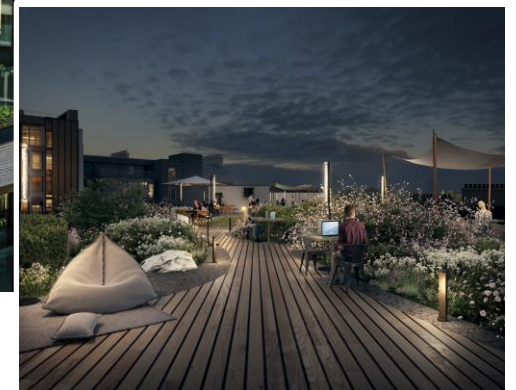



Rooftop 27 Canal

2025



About the property

- 📍 Located on Avenue Flandres, close to the Seine quayside
- ➕ 450 sq. m. landscaped rooftop for your cocktails
- 🌿 Lush vegetation, views of the Bassin de la Villette and the Eiffel Tower
- 🍸 Perfect for hosting fashion shows, cocktail receptions and private parties
- 📅 Available in 2025

Large volume of raw plateaux for your events

Technical features

Convenient lift access to the rooftop

Rooftop located on the 7th floor









Jules Ferry

2025



About the property

-  On Boulevard Jules Ferry, near the Canal Saint Martin
-  2,100 sq. m. in the heart of the 11th arrondissement
-  Generous volumes with high ceilings
-  Fashion shows, showrooms, private dinners, and workshops
-  Available in 2025

Technical features

- Lifts on all floors
- Ceiling height between 2.3 and 4 metres
- Maximum capacity: 260 people



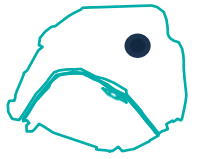

16 Capucines

2025



About the property

- 📍 Located on Rue des Capucines, offering convenient access to public transport and a wide range of amenities
- 📏 440 sq m available
- 🏢 Gecina's headquarters
- 🍸 Conferences, presentations, receptions, cocktails...
- 📅 Available until 2025

Technical features

Total area: 440 sq m

YouFirstCafé:
Surface area: 150 sq m
Ceiling height: 2.4 metres
Capacity: 100 people

Terrace:
Located on the 6th floor, rue Volney
Surface: 180 sq m

Auditorium:
Surface area: 110 sq m
Ceiling heights: between 2.2 and 4.9 metres
Stage: 22 sq m
Capacity: 100 seats
Latest-generation LED screen
High-end sound system



151 Haussmann & 169 Haussmann

2025



About the property

- 📍 Boulevard Haussmann, one of the capital's most popular tourist boulevards
- 📏 151 Haussmann: 623 sq.m. / 169 Haussmann: 328 sq. m., attractive features (mouldings, herringbone parquet flooring, fireplaces)
- 👉 Showroom, cocktail receptions, or Fashion Week preparations.
- 📍 151 Haussmann: A 5th-floor balcony overlooking Boulevard Haussmann
- 📅 Available in 2025

Technical features

151 Haussmann

3.3-meter high ceilings, marble, herringbone parquet flooring and moldings
Elevators
5 floors

169 Haussmann

High ceilings between 2.8 and 3.3 meters, marble, herringbone parquet flooring and moldings
Built of freestone in the 19th century
Elevators
7 floors



Octant & Sextant

2025

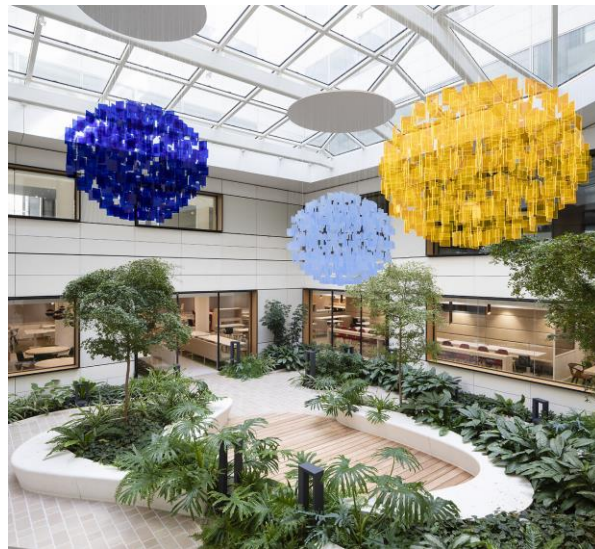

About the property

- 📍 Located close to the Seine riverbanks and Île de la Jatte
- 📏 11 630 sq.m.
- 🏠 Spacious, bright spaces + 210 sq.m. planted rooftop with panoramic view of Île de la Jatte
- 🍸 Fashion show, showrooms, cocktails, private dinners...
- 📅 Available by 2025

Technical features

- Available surface area : 11 630 sq.m.
- Capacity: 1 044 people
- Celling height: between 2.40 and et 2.48 metres
- 10 floors
- 1 green roof
- Places spaces available, including 9 for people with disabilities

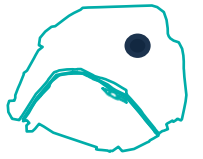

32 Guersant

2025



About the property

- In the heart of the Ternes district, with the Promenade Pereire on its doorstep
- 2,140 sq. ft of renovated workspace
- A quiet and connected upscale neighbourhood
- Sculpted glass and aluminium façade
- Fashion shows, showrooms, cocktails, private dinners...
- Available by 2025

Technical features

Total surface area : 14,400 square metres
Maximum occupancy: 1,200 people
Building height: 9 floors

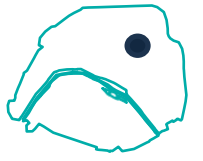

Mirabeau

2025



About the property

- 📍 Located near the Beaugrenelle shopping mall and Javel André Citroën park
- 🏢 Office floors of 1,800 sq m and 1,620 sq m of landscaped outdoor space
- 🌿 A striking facade nestled in a lush green environment
- 🏠 Building with clean lines and clear geometric shapes
- 🍸 Fashion shows, showrooms, cocktails, private dinners
- 📅 Available by 2025

Technical features

- Total surface area: 33,840 sq. m.
- 1,340 sq. m. rooftop with outdoor spaces (including nearly 200 sq. m. accessible)
- Capacity: 1 person/10 sq. m.
- Number of floors: 9 floors
- 2.70 m ceiling height with triple-aspect panoramic views of the Seine and Paris





Quarter Gare de Lyon

2025

About the property

- 📍 Gare de Lyon business hub
- 🏢 Office floors starting from 900 sq. m.
- ☀️ Light-filled, raw spaces offering breathtaking views of Paris
- 🍸 Fashion shows, fitting, showrooms, cocktails, private dinners
- 📅 Available 2025

Tower A:

- Surface: 12,214 sq.m (excluding business center)
- 1,000 sq.m floor space from 2nd to 7th floor and 900 sq.m floors from 8th to 14th floor. Length 60m - Width 8m
- 5 lifts including 1 business center elevator
- Raised floors: yes

Tower B:

- Base: 1,800 sq.m Business center
- 900 sq.m retail gallery
- 340 sq.m. of floor space from 2nd to 14th floors.
- 3 lifts
- Raised floors: no

Building Features:

- Ceiling height: 2.66 m between beams / 2.48 m under beams and 2.30 m in CHC² CHP (corridors) Capacity: 1/10 sq.m office space
- ERP spaces: 1/2 sq.m
- Maximum workforce: 2,200 (tower + business center)
- Number of floors: 15 floors
- Delivery dock - height 3.60 m - night assembly possible
- Maximum noise level: 100 dB











Les Arches du Carreau

2025



About the property

-  Major thoroughfare between the Pont de Neuilly and the Place de l'Étoile
-  80 m long building
-  In the heart of the Allées de Neuilly
-  Very bright - Generous volumes
-  Fashion shows, showrooms, cocktails, private dinners...
-  Available until 2026

Technical features

Advertising :

- In collaboration with our partners, leaders in advertising management.
- 1,200 sq.m. of total advertising space
- Avenue Charles-de-Gaulle: 40 sq.m. long by 20 sq.m. tall
- Les Halles Gourmandes: 20 sq.m. long by 20 sq.m. tall

Events :

- Perfect for fashion shows, showrooms, cocktails, private dinners...
- A 1,500 sq.m. rooftop for exceptional receptions and celebrations
- Ceiling heights up to 2.70 metres
- 3 lifts (750 kg capacity - 10 people)
- 1 sanitary block and a 150 sq.m. marketing suite on the 7th floor, currently being renovated.

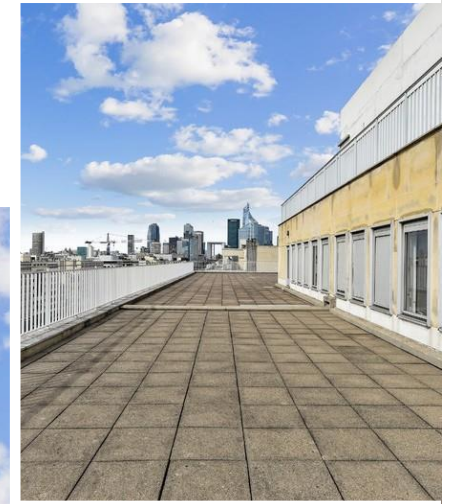



Pop-up stores



Icone

2025



About the property

- 32 Marbeuf Street, a strategic location in the heart of the Golden Triangle
- 680 m² of retail space available** with 8.6 million passersby per year in front of the store
- Connectivity to all urban centres in minutes
- Pop-up store, showroom, sport
- Availability: Dec, 2025



Technical features

Icone has a powerful facade frontage of 11 m and a ceiling height of 3 m.



Quai de Jemmapes

2025



About the property

- 📍 Quai de Jemmapes, overlooking the Canal Saint Martin
- 🏠 190 m² in the 10th arrondissement, in the heart of an urban ecosystem
- ⊕ Charming view of the Canal Saint Martin, connectivity to all urban centres in minutes
- 🏪 Pop-up store, showroom, medical, sport
- 📅 Availability: 2025



Technical features

- Close to public transport (100 m from Jaurès station)
- Number of floors: 2 (117 sq m on the ground floor and 72 sq m in the basement)
- Fully glazed facade frontage

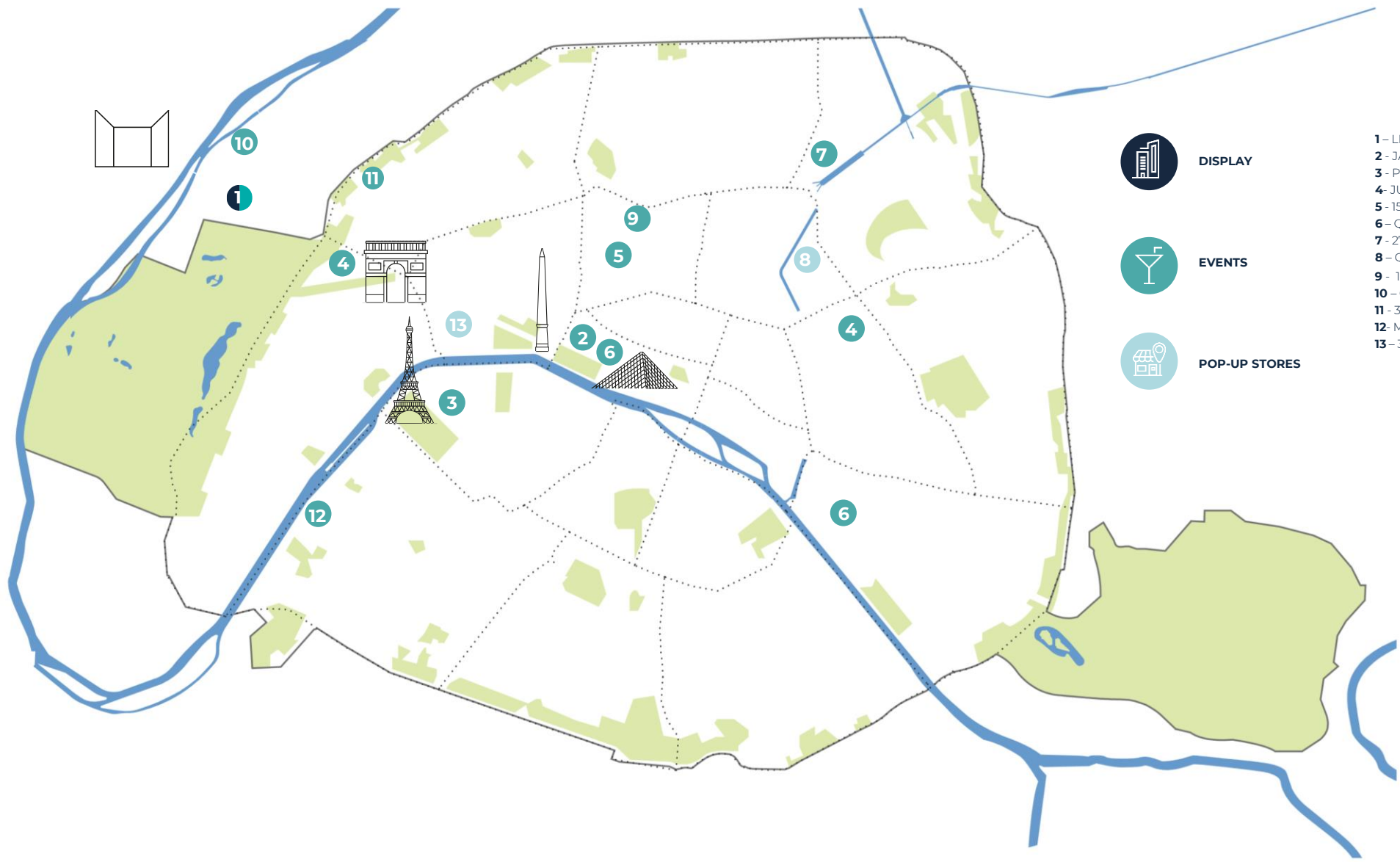

- 1 - LES ARCHES DU CARREAU
- 2 - JARDIN VENDÔME
- 3 - PERGOLÈSE
- 4 - JULES FERRY
- 5 - 151 HAUSSMANN & 169 HAUSSMANN
- 6 - QUARTER GARE DE LYON
- 7 - 27 CANAL
- 8 - QUAI DE JEMMAPES
- 9 - 16 CAPUCINES
- 10 - OCTANT & SEXTANT
- 11 - 32 GUERSANT
- 12 - MIRABEAU
- 13 - 32 MARBEUF

Contact



Maryll
Henderyksen

Head of marketing

Phone: 07 88 59 83 90

E-mail: maryllhenderyksen@gecina.fr

Gecina

16 rue des Capucines,
75002 Paris
gecina.fr